

INTRODUCTION



Washington Department of
FISH and WILDLIFE

Home Work / Reading Assignments

Read the following chapters and do the Chapter Reviews at the end of each chapter.

Date	Chapter
Day 1	9,10,11,12,15
Day 2	2,3,4,5
Day 3	1,6,12,14, Appendix A
Day 4	7,8,13
Day 5	Chapters Review pgs. 108 -111, Appendix B pgs. 102-105
Day 6	1 – 2 hr Range Day

Additional Study Material

- <http://www.hunter-ed.com/wa/index.htm>
- <http://homestudy.ihea.com/>

Both sites offer free online practice exams!! If you can pass the online exam, you should be able to pass the written exam.

Additional Information

Ways to Avoid Range Day Failures

- **DO NOT** Place your finger on or near the firearms trigger guard unless you are ready to shoot.
- **MUZZLE CONTROL, MUZZLE CONTROL, MUZZLE CONTROL!!!!** Always know where the muzzle is pointing and make sure it is always pointed in a safe manner.
- Obey ALL instructions given to you by the instructor.
- Treat all firearms as if they were loaded.

Donations:

We are a VOLUNTEER team of Instructors. If you would like to help defer the cost of Saturday's range, please see me (Jim Brown) before class or during a break.

What do donations go towards?

- Hearing / Eye Protection
- Clay / Paper Targets
- **Ammunition (This has greatly increased in the past few years)**
- Teaching / Training Aids / Software

Please Note: Donations **ARE NOT USED** for our personal Benefit. They go towards out of pocket expenses associated with this course and are very much appreciated.

Class Location

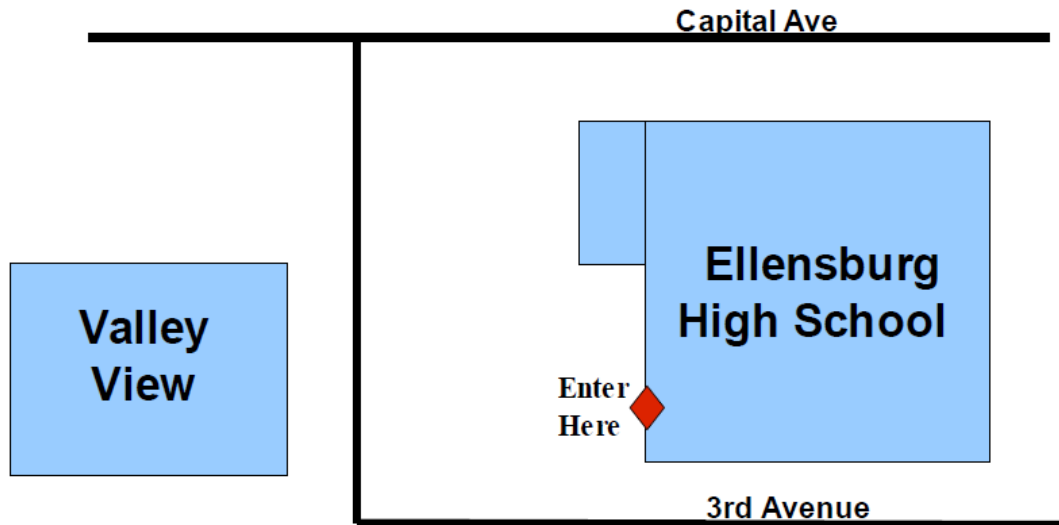

* Park on 3rd Ave - North End of High School

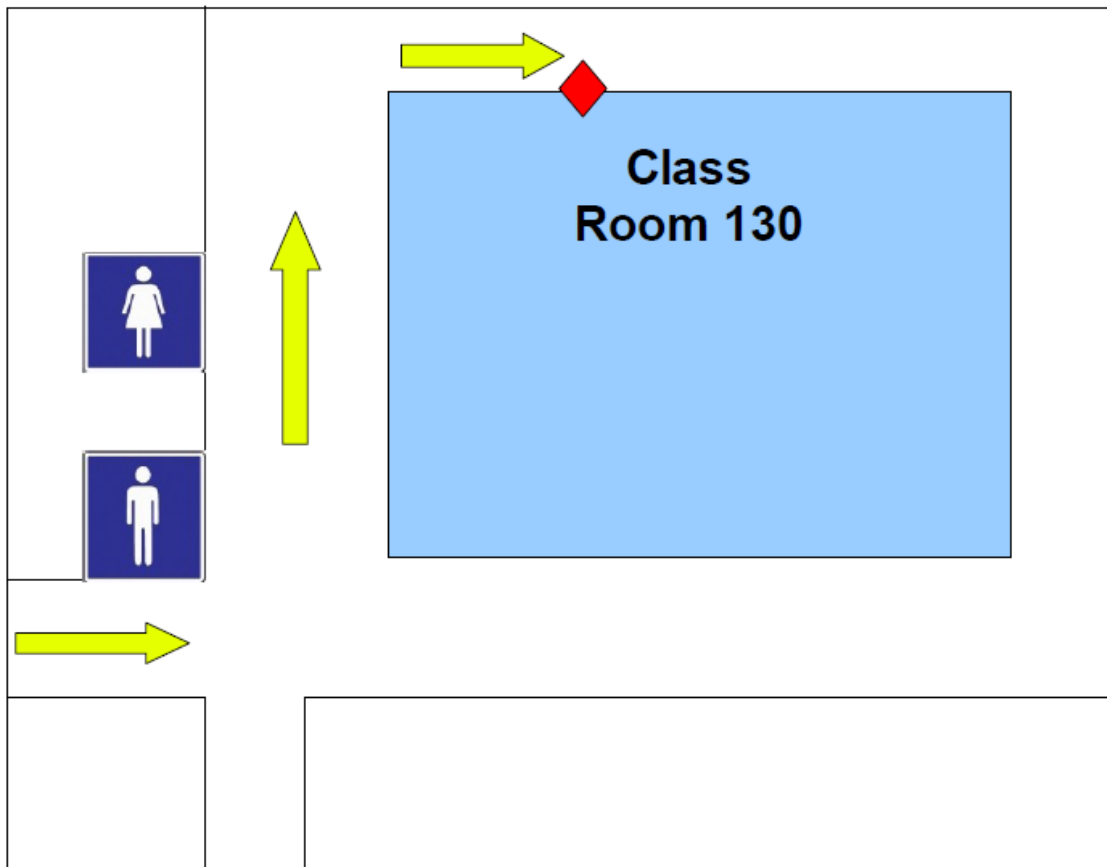

X ← Follow Durr Road Approximately 2.5 Miles

If you get lost or have an unexpected emergency please Contact me ASAP.

Jim Brown (509) 929-6280

